



USER MANUAL

24INCH 2.7 cu. ft. COMPACT FRONT LOAD WASHER

EFL2724BW

Product may vary. Please refer to the actual product.

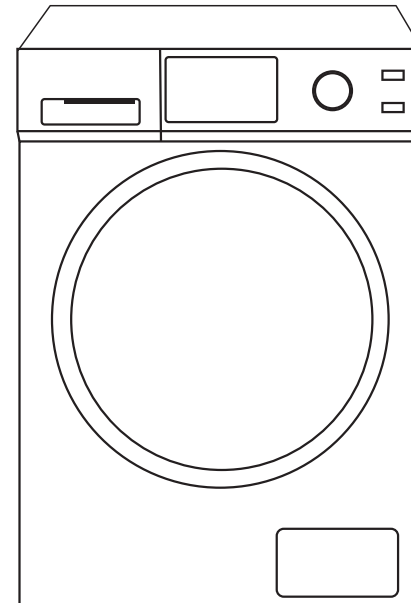

CONTACT US:

Element, the Element Logo, and Bring it home are trademarks of Element Brand Holding, LLC. All other trademarks are the property of their respective owner, who has not sponsored, endorsed, or approved this product. ©2024 Element Appliance Company, LLC. All rights reserved.

Distributed by Element Appliance Company, LLC
Augusta, GA 30909

For service, support and warranty information:
Call 888.842.3577, email us at customerservice@elementelectronics.com or visit www.elementelectronics.com

Before using your new product, please read these instructions to prevent any damage.

REGISTER YOUR WASHER

Thank you for purchasing the Element 24Inch 2.7 cu. ft. Compact Front Load Washer.
If you have questions about your washer, our customer support team is ready to help:

- **Phone:** 888-842-3577
- **Email:** customerservice@elementelectronics.com

To register your washer, go to <https://elementelectronics.com/register>, fill out the Product Registration form, and upload a picture of your receipt. Your serial number is located on the rating label on the back of your washer.

Use the space below to record information about your washer and keep your original purchase receipt for future reference. You'll need this information to receive warranty service.

 2.7 cu.ft. Washer	
Model Number:	-----
Serial Number:	----- (located on the rating label on the back of your washer)
Date of Purchase:	-----
Keep this information and your original purchase receipt to receive warranty service.	

Contents

Contents

Safety and Precautions.....	3
Safety and precautions.....	3
Important safety instructions.....	4
Grounding instructions.....	7
Before operating this machine.....	7
Attention should be paid to protecting the machine.....	7
Cautions during handling machine.....	7
Cautions when washing clothes.....	8
Installation Requirements.....	9
Tools and parts.....	9
Location requirements.....	10
Installation clearances.....	10
Electrical requirements.....	10
Washer dimensions.....	11
Unpacking the washing machine.....	11
Installation Instructions.....	12
Dispose the packing materials.....	12
Remove transport bolts and foam.....	12
Select the location.....	12
Install inlet pipe.....	13
Drain system options.....	13
Level the washer.....	14
Electrical connection.....	14
Operating Instructions.....	15
Checklist and preparation before washing clothes.....	15
View of control panel.....	19
Washing clothes at first time.....	22
Select the procedure.....	22
Table of washing procedures.....	23
Care and Cleaning	25
Troubleshooting Tips.....	29
Remove the Problems.....	30
Appendix.....	31
Technical Specifications.....	32
Warranty.....	33

Safety and Precautions

Safety and precautions

This manual contains important information on the installation, use, and care of your appliance. Please read this manual carefully before installation and operation of this machine to prevent injury and property damage.

WHAT YOU NEED TO KNOW ABOUT SAFETY INSTRUCTIONS

Warnings and Important Safety Instructions in this manual DO NOT cover all possible conditions and situations that may occur. It is your responsibility to use common sense, caution and care when installing, maintaining and operating your washer.

IMPORTANT SAFETY SYMBOLS AND PRECAUTIONS



WARNING

This indicates that hazards or unsafe practices may cause **serious personal injury or death**. To reduce the risk of fire, explosion, electric shock, or personal injury when using your washer, these basic safety precautions **SHOULD** be followed.

State of California Proposition 65 Warnings



WARNING

The California Safe Drinking Water and Toxic Enforcement Act requires the Governor of California to publish a list of substances known to the State of California to cause cancer, birth defects, or other reproductive harm, and requires business to warn of potential exposure to such substances.

This product contains a chemical known to the State of California to cause cancer, birth defects, or other reproductive harm. This appliance can cause low-level exposure to some of the substances listed, including benzene, formaldehyde, and carbon monoxide.

Safety and Precautions

Important safety instructions

SAVE THESE INSTRUCTIONS



WARNING

- WARNING – To reduce the risk of fire, electrical shock, or injury to persons when using your appliance, follow basic precautions, including the following:
- Read all instructions before using the appliance.
 - Do not wash articles that have been previously cleaned, washed, soaked, or spotted with gasoline, dry-cleaning solvents, or other flammable or explosive substances, as they give off vapors that could ignite or explode.
 - Do not add gasoline, dry-cleaning solvents, or other flammable or explosive substances to the wash water. These substances give off vapors that could ignite or explode.
 - Under certain conditions, hydrogen gas may be produced in a hot-water system that has not been used for 2 weeks or more. **HYDROGEN GAS IS EXPLOSIVE**. If the hot-water system has not been used for such a period, before using a washing machine, turn on all hot-water faucets and let the water flow from each for several minutes. This will release any accumulated hydrogen gas. As the gas is flammable, do not smoke or use an open flame during this time.
 - Always unplug the washing machine from the power supply before attempting any service. Disconnect the power cord by grasping the plug, not the cord.
 - To reduce the risk of fire, clothes, cleaning rags, mop heads and the like which have traces of any flammable substance, such as vegetable oil, cooking oil, petroleum based oils or distillates, waxes, fats, ect., must not be placed in the washing machine. These items may contain flammable substances which, even after washing, may smoke or catch fire.
 - Never place items in the washer that have been dampened with gasoline or any combustible or explosive substance. Do not wash or dry anything that has been soaked in or spotted with any type of oil (including cooking oils). Doing so can result in fire, explosion, or death.
 - Do not allow children to play on or in the appliance. Close supervision of children is necessary when the appliance is used near children.
 - Pets and kids may climb into the machine. Check the machine before every operation.
 - Glass door or protector may be very hot during the operation. Keep kids and pets far away from the machine during the operation.
 - This machine is not intended for use by persons (including kids) with reduced physical, sensory or mental capabilities, or lack of experience and knowledge, unless they have been given supervision or instruction concerning use of the machine by a person responsible for their safety.
 - Kids should be supervised to ensure that they do not play with the machine.
 - When children become old enough to operate the appliance, it is legal responsibility of the parents or legal guardians to ensure that they are instructed in safe practices by qualified persons.

Safety and Precautions

Important safety instructions

SAVE THESE INSTRUCTIONS



WARNING

- Do not machine wash fiberglass materials (such as curtains and window coverings that use fiberglass materials). Small particles may remain in the washing machine and stick to fabrics in subsequent wash loads causing skin irritation.
- Before the appliance is removed from service or discarded, remove the door and cut off the power cord.
- Do not reach into the appliance if the tub or agitator is moving.
- Do not install or store this appliance where it will be exposed to the weather.
- Do not tamper with controls.
- Do not repair or replace any part of the appliance or attempt any servicing unless specifically recommended in the user-maintenance instructions or in published user-repair instructions that you understand and have the skills to carry out.
- Pull the plug out from the power socket before cleaning or maintenance.
- Make sure that all pockets are emptied.
- Sharp and rigid items such as coins, nails, screws, or stones etc. may cause serious damages to this machine.
- Pull the plug out and cut off water supply after the operation.
- Check whether the water inside the drum has been drained before opening its door. Do not open the door if there is any water visible.
- Do not try to repair the machine by yourself. The machine may be damaged or more troublesome repair work may be caused and even dangerous operation may take place if it is repaired by any inexperienced or unqualified staff.
- If the plug (power cord) is damaged, it should be replaced by the manufacturer or a service agent to avoid any danger.
- Take care that power voltage and frequency should be identical to those of washing machine.
- Do not use any socket with rated current less than that of washing machine.
- Never pull the power plug out with wet hands.
- To ensure your safety, the power plug must be inserted into an earthed three-pole socket. Check carefully and make sure that your socket is properly and reliably earthed.
- This machine should be repaired only by an authorized service center and only authentic accessories can be used.
- An appliance should be clearly and permanently marked with a warning that the appliance is intended for use only with fabrics that have been washed with water as a cleaning agent.
- To reduce the risk of fire, do not dry articles containing foam rubber or similarly textured rubber like materials.

Safety and Precautions

Important safety instructions

SAVE THESE INSTRUCTIONS



WARNING

- If connected to a circuit protected by fuses, use time-delay fuses with this appliance.
- Do not use fabric softeners or products to eliminate static unless recommended by the manufacturer of the fabric softener or product.

Safety and Precautions

Grounding instructions



WARNING

- This appliance must be grounded . In the event of a malfunction or breakdown, grounding will reduce the risk of electric shock by providing a path of least resistance for the electric current. This appliance is equipped with a cord that has an equipment grounding conductor and a grounding plug. The plug must be plugged into an appropriate outlet that is properly installed and grounded in accordance with all local codes and ordinances.

WARNING-Improper connection of the equipment grounding conductor can result in electric shock. Connect to individual branch Circuit. Check with a qualified electrician or serviceman if you are in doubt as to whether the washer is properly grounded.

DO NOT modify the plug provided with the appliance if it will not fit the outlet . Please have a proper outlet installed by a proper outlet installed by a qualified electrician.

Before operating this machine



WARNING

- Packing materials may be dangerous to the kids. Keep all packing materials (plastic bags, foams etc) far away from children.
- Washing machine should not be installed in a bathroom or very wet rooms as well as in the rooms with explosive or caustic gases.
- The water and electrical devices must be connected by a qualified technician in accordance with the manufacturer's instructions and local safety regulations.
- Before operating this machine, all packages and transport bolts must be removed. Otherwise, the washing machine may be seriously damaged while washing the clothes.
- Before washing the clothes for the first time, the washing machine should be operated in cotton and hot water procedures without the clothes inside .
- This washing machine is for indoor use only.

Attention should be paid to protecting the machine



WARNING

- Do not climb up and sit on top cover of the machine.
- Do not lean against machine door.
- Do not close the door with excessive forces. If it is found difficult to close the door, check if the excessive clothes are put in or distributed well.

Cautions during Handling Machine



WARNING

- Transport bolts should be reinstalled to the machine by a specialized person.
- The accumulated water should be drained out of the machine.
- Handle the machine carefully. Never hold each protruded part on the machine while lifting.
- Machine door can not be used as the handle during the conveyance.

Safety and Precautions

Cautions when washing clothes



WARNING

- Cold city water should be used and hot water may be also connected according to the local situations.
- Your washing machine is only for home use and is only designed for the textiles suitable for machine washing.
- Flammable and explosive or toxic solvents are forbidden. Gasoline and alcohol etc. should not be used as detergents. Only select the detergents suitable for machine washing, especially for front loading.
- It is forbidden to wash carpets.
- Be careful of burning when washing machine drains hot washing water.
- Never refill the water by hand during washing.
- After the program is completed, open the door after the bell or disconnect the power supply to the machine.
- Remember to disconnect water and power supply immediately after the clothes are washed.
- Always follow the fabric care instructions recommended by the clothing manufacturer.
- Do not use the washing machine if it has a worn power cord or loose plug. Contact an authorized service agent.
- Do not operate the washing machine if any guards, panels and/or fasteners except transport fixing bolts have been removed. Check the fill hose connections on a regular basis to ensure that they are tight and not leaking.
- Do not operate the washing machine if parts are missing or broken.
- Do not touch the door if washing at high temperatures.

Note:

- The Important Safeguards and Warnings indicated in this manual do not cover all possible conditions which may occur. Common sense, caution and care must be exercised when installing, maintaining or operating the washing machine.
- Always contact your dealer, distribute, service agent or the manufacturer about any problems or conditions that you do not understand.

Installation Requirements

Installation requirements



WARNING

1. This machine must be earthed properly. If there is any short circuit, earthing can reduce the danger of electrical shock. This machine is equipped with a power cord, which includes a plug and earthing wire at earthing terminal.
2. Washing machine should be operated in a circuit separate from other electrical appliances. Otherwise, the power protector may be tripped or fuse may be burned out.

Failure to comply with these warnings could result in serious personal injuries.

Note: Environmental Protection

- If you plan to dispose this machine, comply with the local waste disposal regulations. Cut off the power cord so that it will not be put into reuse. Remove the door so that children and animals will not be trapped in the machine.
- Do not use excessive detergents.
- Decontaminant and bleach can be used to pre-treat the stains on the clothes only when very necessary.

Tools and parts

Gather the required tools and parts before starting installation. The parts supplied are in the washer drum.

- 1/4" nut driver 3/8" socket with ratchet
- 3/8" open-end wrench
- Adjustable wrench or 7/16" socket with ratchet
- Adjustable wrench or 9/16" open-end wrench
- Channel-lock adjustable pliers
- Carpenter's level

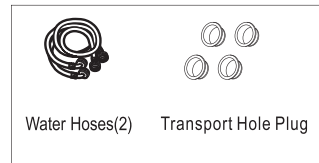

Installation Requirements

Location requirements

Selecting the proper location for your washer improves performance and minimizes noise and possible washer "walk." Your washer can be installed under a custom counter, or in a basement, laundry room, closet, or recessed area. See "Drain System." Companion appliance location requirements should also be considered. Proper installation is your responsibility.

You will need

1. A water heater set to deliver 120°F (49°C) water to the washer.
2. A grounded electrical outlet located within 6 ft. (1.8 m) of where the power cord is attached to the back of the Washer. See "Electrical Requirements."
3. Hot and cold water faucets located within 4 ft. (1.2m) of the hot and cold water fill valves, and water pressure of 20-100 psi (137.9-689.6 kPa).
4. A level floor with a maximum slope of 1" (25mm) under the entire washer. Installing the washer on soft floor surfaces, such as carpets or surfaces with foam backing, is not recommended.
5. A sturdy and solid floor to support the washer with a total weight (water and load) of 200lbs.
6. Do not operate your washer in temperatures below 32°F (0°C). Some water can remain in the washer and can cause damage in low temperatures.

Installation clearances

1. The location must be large enough to allow the washer door to be fully opened.
2. Additional spacing should be considered for ease of installation and servicing. The door opens more than 90°, and it is not reversible.
3. Additional clearances might be required for wall, door, and floor moldings.
4. Additional spacing of 25mm on all sides of the washer is recommended to reduce noise transfer.
5. Companion appliance spacing should also be considered.

Electrical requirements

WARNING



Electrical Shock Hazard

Connect to grounded 3 prong outlet with an individual 12 amp branch circuit protected by a 12 amp circuit breaker.
Connect to individual branch circuit.
Do not remove ground prong.
Do not use an adapter.
Do not use an extension cord.
Failure to follow these instructions can result in electrical shock, fire, or death.

Installation Requirements

Electrical requirements

1. A 120v, 60Hz, a only, 15-or 20amp, fused electrical supply is required. A time-delay fuse or circuit serving only this appliance be provided .
2. This washer is equipped with a power supply cord having a 3 prong grounding plug.
3. To minimize possible shock hazard , the cord must be plugged into a mating, 3 prong, grounding type outlet, grounded in accordance with local codes and ordinances.
If a mating outlet is not available, it is the personal responsibility and obligation of the customer to have the properly grounded outlet installed by a qualified electrician.
4. If codes permit and a separate ground wire is used, it is recommended that a qualified electrician determine that the ground path is adequate.
5. Do not ground to a gas pipe.
6. Check with a qualified electrician if you are not sure the washer is properly grounded.
7. Do not have a fuse in the neutral or ground circuit.

Washer dimensions

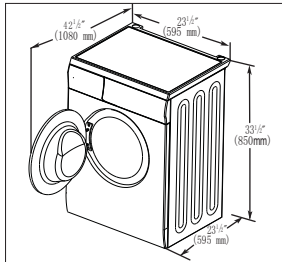

The dimensions shown are for the recommended spacing. Custom counter installation

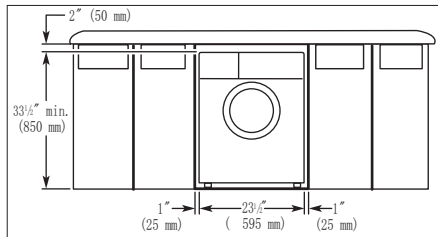

Unpacking the washing machine

Unpack your washing machine and check if there is any damage during the transportation. Also make sure that all the items (as shown in Page 5) in the attached bag are received. If there is any damage to the washing machine during the transportation, or any item is missing, contact the local dealer immediately.

Installation Instructions

Dispose the packing materials

The packing materials of this machine may be dangerous to children. Dispose of them properly and avoid easy touch by children. Dispose the related packing materials according to the relevant local regulations. Do not throw the packing materials away together with the other daily living rubbishes.

Remove transport bolts and foam

Before using this washing machine, transport bolts must be removed from the backside of this machine. Take the following steps to remove the bolts:

1. Loosen all bolts with spanner and then remove them.
2. Cover the holes with transport hole plugs.
3. Keep the transport bolts properly for future use.

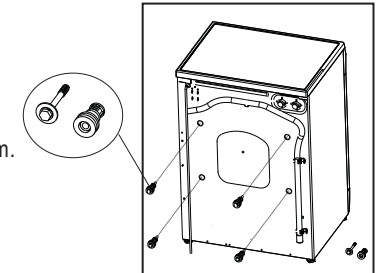

Make sure the small triangle foam is removed with the bottom one together. If not, lay the unit down with side surface, then remove the small foam from the unit bottom manually.

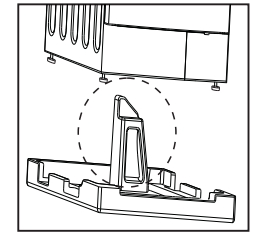

Select the location

Before installing the washing machine, the location characterized as follows should be selected:

- Rigid, dry, and level surface (if not level, please make it level with reference to the following figure "Adjust Leg")
- Avoid direct sunlight
- Sufficient ventilation
- Room temperature is above 32°F
- Keep far away from the heat resources such as coal or gas.
- Make sure that the washing machine will not stand on power cord.
- Do not install the washing machine on the carpet floor.

Connect inlet pipe

Connect the inlet pipe as indicated in the figure. For the model which has a hot valve, connect the hot valve to hot water tap.

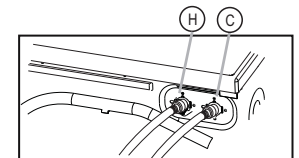

Installation Instructions

Install inlet pipe

1. Connect the elbow to the tap and fasten it clockwise.
2. Connect the other end of inlet pipe to the inlet valve at the backside of washing machine and fasten the pipe tightly clockwise.

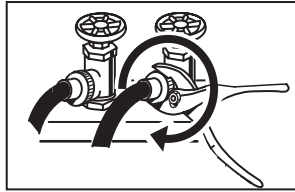

Note: after connection, if there is any leakage with the hose, then repeat the steps to connect inlet pipe. The most common type of tap should be used to supply water. the tap is square or too big, then standard tap should be changed.

Drain system options

Standpipe drain system – wall or floor (views A & B).

The standpipe drain requires a minimum diameter standpipe of 2" (50mm). The minimum carry-away capacity can be no less than 17 gal. (64 L) per minute. The top of the standpipe must be at least 60cm high and no higher than 100cm from the bottom of the washer.

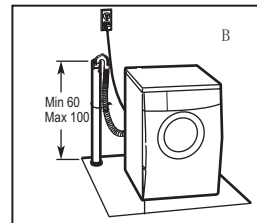
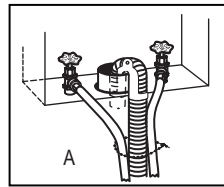

Laundry tub drain system (view C)

The laundry tub needs a minimum 20gal (76L) capacity. The top of the laundry tub must be at least 60cm above the floor.

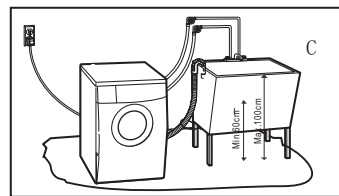

Floor drain system (view D). The floor drain system requires a siphon break that may be purchased separately.

See "Tools and parts." The siphon break must be a minimum of 28" (710mm) from the bottom of the washer.

Additional hoses might be needed.

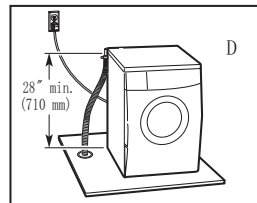

Installation Instructions

Level the washer

1. When positioning the washing machine, first check if the legs are closely attached to the cabinet. If not, turn them to their original positions with hand or spanner and tighten the nuts with spanner.
2. After positioning the washing machine, press four corners on top cover of washing machine in sequence. If the washing machine is not stable when being pressed, this leg should be adjusted.

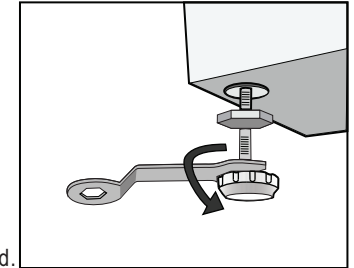

3. Ensure the positioning status of washing machine. Loosen the lock nut with spanner and turn the leg with hand until it closely contacts with the floor. Press the leg with one hand and fasten the nut closely to the cabinet with the other hand.

4. After being locked properly, press four corners again to make sure that they has been adjusted properly. If it is still unstable, it has to repeat Steps 2 and 3.

5. Put a solid cylinder (e.g. pop cans) opposite on the top cover of the washing machine from in the left, right, front and back directions. If the cylinder keeps stable, the washing machine is positioned level. If it rolls, the washing machine is positioned unlevel. The rolling direction is the direction of lower ground surface. Then the two legs in this direction should be raised at the same time until the washing machine is level. Steps 1~3 are repeated to make the bottom legs closely against the ground and the nuts should be locked tightly.

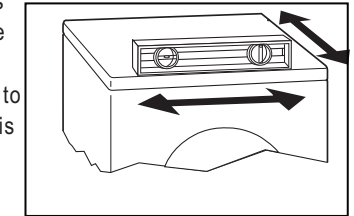

Electrical connection

- The maximum current through the unit is 12A when you are using its heating function, make sure the power supply system (current, power voltage and wire) at your home can meet the normal loading requirements of the electrical appliances.
- Connect the power to a socket which is correctly installed and properly earthed.
- Make sure the power voltage at your place is same to that in the machine's rating label.
- Power plug must match the socket and cabinet must be properly and effectively earthed.
- Do not use multi-purpose plug or socket as extension cord.
- Do not connect and pull the plug out with wet hands.
- When connecting and pulling the plug out, hold the plug tightly and then pull it out. Do not pull power cord forcibly.
- If power cord is damaged or has any sign of being broken, special power cord must be selected or purchased from its manufacturer or service center for replacement.

Operating Instructions

Operating instructions



WARNING

WARNING – To reduce the risk of fire, electric shock, or injury to persons, read the IMPORTANT SAFETY INSTRUCTIONS before operating this appliance.

Checklist and preparation before washing clothes

Please read this operation method carefully to avoid the troubles of washing machine and damages of clothes.

Check if the first-washed clothes will be decolorized.

- After a white towel touched with liquid detergent is used to wash the invisible corners of the clothes, check if the white towel is stained with clothes' original color.
- As for the scarves and those clothes that easily get decolorized among imported clothes, wash them separately before washing.
- As for the stains on sleeves, collars and pockets, use the liquid detergent and gently wash it with a brush. Finally, put them into the washing machine to achieve more ideal washing effects.
- As for temperature-sensitive clothes, they should be washed as required in the labels. Otherwise, it may cause color change or distortion.

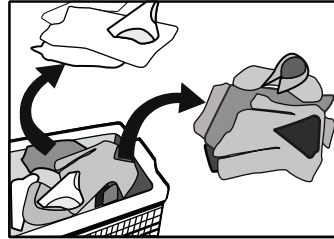

Keep in mind:

Never put the clothes to be washed in washing machine for a long period of time. Otherwise it may get moldy and cause spots. Therefore, wash the clothes in time. The clothes also may get color changed or distorted if they are not washed according to the stated washing temperature.

Clothes that cannot be washed by washing machine

The clothes that may get distorted if being immersed in water: Ties, waistcoats, western-style clothes, outer garments etc. may have obvious shrinkage if being immersed in water; the decolorized clothes such as blended spinning clothes of artificial fiber etc.

Operating Instructions

Checklist and preparation before washing clothes

- Wrinkle-style, embossed, resin clothes etc. may get distorted when being immersed in water. Among cotton and wool materials, the clothes that get easily distorted are wrinkle-style silk, fur products and fur decorations.
- Clothes with decoration, long dress and traditional clothes etc are the products to get decolorized easily.
- Do not wash clothes without material labels and washing requirements.
- Never wash clothes stained with chemicals such as gasoline, petroleum, benzene, paint thinner and alcohol.

Pay attention in regards to detergents

- "Low bubble" detergent or washing powder or washing powder special for drum washing machine should be selected according to fiber types (cotton, synthetic fiber, soft products and wool products), colors, washing temperatures, dirty degrees and types. Otherwise, excessive bubbles may be generated and overflowed out of the drawer so that accidents may take place.
- Bleacher belongs to alkali type and can damage clothes, so it is suggested to use as little as possible.
- Powder detergents can easily leave residues in the clothes and generate a bad smell, so they should be sufficiently rinsed.
- Detergent cannot easily completely dissolve if there is too much detergent or water temperature is rather low. It can remain in clothes, pipes and washing machines to pollute the clothes.
- Washing shall follow the weight of clothes, dirty degrees, local water hardness as well as the recommendations from the detergent manufacturers. Please consult the water company if you are not clear of water hardness.

Note:

Keep detergents and additives in safe and dry places out of touch by kids.

Take items out of pockets:

Check clothes pockets that are to be washed and empty the rigid items such as decorations and coins, otherwise the washing machine may be damaged or have abnormal troubles.

For the clothes to be washed, they are classified according to the following characteristics:

The symbol types of care labels: the clothes to be washed are classified into cotton, blended fiber, synthetic fiber, silk, wool and artificial fiber.

Color: white and colorful colors should be identified. All new colorful articles should be washed in a separate way.

Operating Instructions

Checklist and preparation before washing clothes

Size: the articles of different sizes are washed together to increase the washing effects.
Sensitivity: soft articles shall be washed separately. As for new pure wool textiles, curtains and silks, the soft washing procedure shall be selected. Check the labels in all washing articles. The clothes should be sorted before being put into washing machine. As for the curtains with hooks, the hooks should be removed before being washed.
The decorations on the clothes may damage the washing machine. As for the clothes with buttons or embroideries, they should be turned over before being washed.

Clean up fasteners:

Zippers should be zipped closed and buttons or hooks should be fixed. The loose band or ribbon should be bound together.



WARNING

It is suggested to put bras into the pillow slip with zip or buttons sealed to prevent the steel wire from popping out of bras into the drum and damaging the machine.

Especially delicate textiles such as laced curtains, straightjackets, small articles (tight socks, handkerchiefs, ties etc.) should be put into string bag for washing.

When washing a single big and heavy dress such as Turkish towels, jeans, wadded jackets etc., it may easily cause great eccentricity and give alarm due to great unbalance. Therefore it is suggested to add one or two more clothes to be washed together so that draining can be done smoothly.

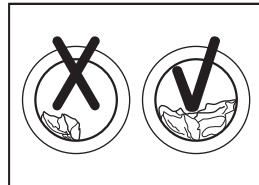
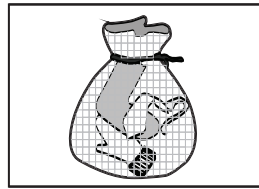

Clean away dusts, stains and pet hairs from the clothes.

The clothes may be damaged and disturb washing effects during the friction between dusts, stains and clothes.

To protect baby skin

Baby articles (baby clothes and towels) including napkins should be washed separately. If they are washed together with the adults' clothes, they may be infected. Rinsing times should be increased to ensure the thorough rinsing and cleaning without the detergent residues.

It is suggested that the parts that are easily stained such as white sockets, collars and sleeves etc. should be hand washed before being put into washing machine to achieve more ideal washing effects.

Use powder or liquid detergents. The residues of the soap could remain in the gaps of the clothes if soap is used.

Operating Instructions

Checklist and preparation before washing clothes

The clothes which easily get fuzzed shall be turned over for washing

The clothes which easily get fuzzed should be washed separately; otherwise the other articles can be stained with dust and thrum etc. Preferably, black clothes and cotton clothes should be washed separately because they can easily get stained with the thrums of other colors when being washed together.

Check before washing.

Washing machine should not wash water-proof materials (ski suits, outside napkin pads, curtains).

As for the fiber products that water can not get soaked easily into such as water-proof cushions, and clothes, it is better not to wash. Otherwise there will be water bursting out or abnormal vibration to cause danger while rinsing and draining so that the clothes also may be damaged (such as outside napkin pads, raincoats, umbrella, ski suits, car covers, sleeping sacks etc.).

Cautions during draining

Draining of normal clothes:

Moistures of washings are drained through drain hole.

Draining of water-proof clothes and fiber products:

In the normal washing and draining status, moistures of water-proof clothes and fiber products cannot be drained while water is gathered in one direction so that the eccentricity of washing machine is too great and vibration or moving is caused.

Operating Instructions

View of control panel

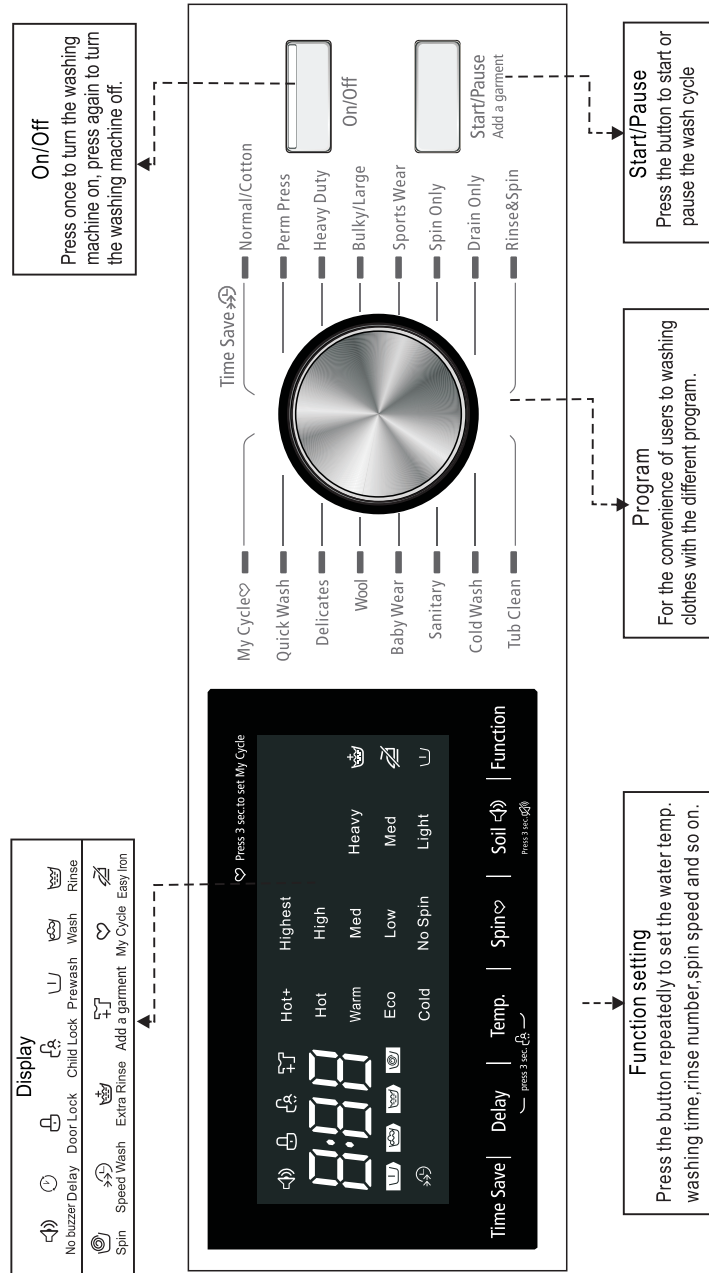

Note:

1. The control panel line chart is for reference only, refer to real product as standard.

Operating Instructions

View of control panel

View of the program

- **Normal/Cotton**
Hard-wearing textiles, heat-resistant textiles made of cotton or linen.
- **Heavy Duty**
This program is intended for washing the heavy clothing like towels.
- **Bulky/Large**
This program is intended for washing the large clothing .
- **Sports Wear**
Washing activewear.
- **Spin Only**
Extra spin with selectable spin speed.
- **Rinse&Spin**
Extra rinse with spin.
- **Tub Clean**
This program is specially set in this machine to clean the drum and tube. It applies high temperature sterilization to washing clothes more green. When this procedure is performed, clothes and other wash settings cannot be added. When proper amount of chlorine bleaching agent is put in, the barrel cleaning effect will be better. The customer can use this procedure regularly according to the need.
- **Quick Wash**
Extra short program that is suitable for lightly soiled washing of small amounts of laundry.
- **Delicates**
For delicate, washable textiles, e.g. made of silk, satin, synthetic fibres or blended fabrics.
- **Sanitary**
Give full play to its active enzyme washing powder, with 60°C Lord washed and prewash function, suitable for difficult to wash the clothes.
- **Wool**
You can select this procedure to wash the wool textiles labeled with "Machine Wash". Please select the proper washing temperature according to the label on the articles to be washed. Furthermore, the proper detergent shall be selected for wool textiles.
- **Perm Press**
Moderate strength of washing. This function can be used to reduce the wrinkles of clothes.
- **Baby Wear**
Help make the baby's clothes cleaner along with having the rinse performance better to protect the baby's skin.
- **My Cycle**
Press Spin for 3sec. for My Cycle for the program.
- **Cold Wash**
Cold water flows in during wash.
- **Drain Only**
Drain out the water.

Operating Instructions

View of control panel

-Timed Dry

Load (lb)	Dry programme (min)	Dry Capacity (lb)	The reference weight of dry clothes	moisture content
26lb	59	1.76lb	4 shirts or 1 jean, 1 synthetic	60%
	89	2.21lb	4 shirts, 1 T-shirt or 1 jean, 1 synthetic, 1 T-shirt	60%
	194	6.61lb	3.0kg mix	60%

The special function

- **Time Save** The function can decrease the washing time.

-Child Lock

To avoid that the washing procedure cannot operate normally due to malfunction by children during the washing procedure, you can select this function. In this case, the other buttons except On/Off button cannot work, at this state, the machine power off when press the key on/off.

Press Function and Select together for 3 seconds during the running procedure, the buzzer will beep. The Start/Pause button and the rotary switch will be locked. Press the two buttons for 3 seconds together and buzzer will beep to release the lock. If the power supply is cut off, the child lock will release. For washing machines, turn the power supply off, and the child lock stays on.

The child lock will not be canceled until all procedures are completed.

- Delay

Delay function can be set with this button, the delaying time is 0-24H.

Set the delay function:

1. Select a program
2. Press the Delay button to choose the time
3. Press Start/Pause to start the Delay operation.

Cancel the Delay function:

Press the Delay button until the display is 0H. It should be pressed before starting the program. If the program already started, press the On/Off button.

Notes: If there is any break in the power supply while the machine is operating, a special memory stores the selected program. When the power is restored, press the Start/Pause button and the remaining time continues.

- Add a garment

This operation can be executed during the washing procedure. When the drum of the washer machine is still rolling and there is large amount of water with high temperature in the drum. The state is unsafe and the door cannot be opened forcefully. To press "Start/Pause" for 3sec. to reload, and start the clothes adding in the midway function.

Follow the steps as below:

1. Wait until the drum stops rotation.
2. The door lock is unlocked.
3. Close the door when the clothes needs are loaded and repress the "Start/Pause" button.

Notes; Don't use the Add Garment function when the water surface over the edge of the inner tub and the temperature is higher.

Operating Instructions

-**Extra Rinse** The laundry will undergo extra rinse once you select it.

-**Mute** Press the [Soil] button for 3sec., the buzzer is mute.

-**Soil** It is suitable for different level of soil (from light to heavy).

The default level is light and would increase washing time when choosing extra soil level.

-**Temp.** Press the button to regulate the temperature.

-**Spin** Press the button to change the spin speed.

-**Pre wash** The prewash function can get an extra wash before main wash. It is suitable for washing the dirt rising on your clothes. Once selected, put the detergent into the Case (I).

Washing clothes for first time

Before washing clothes the first time, the washing machine should be operated in one round of the whole procedures without clothes in as follows:

1. Connect power source and water.
2. Put a little detergent into the box and close it.
3. Press the button "On/off".
4. Press the button "Start/Pause".

The drawer is separated as follows:

I: Pre-detergent or washing powder.

II: main detergent, softener, pre-dip, bleaching or decontaminating products.

☼: washing additive, such as fabric softener or tackifier.

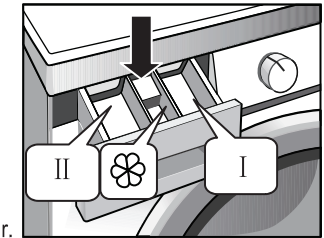

Put detergent into washing machine.

1. Pull out the drawer.
2. Fill pre-detergent into Case I (when necessary).
3. Fill detergent into Case II.
4. Fill softener into Case ☼ (when necessary).

Notes:

- As for the agglomerated orropy detergent or additive, before they are poured into the detergent box, it is suggested to use some water for dilution to prevent the inlet of detergent box from being blocked and overflowing while filling water.
- Choose the suitable type of detergent for the various washing temperature to get the best washing effect with less water and energy consumption.

Start up washing machine

Connect to power. Check if water pipes are connected properly. Open the tap completely. Put in the clothes to be washed and fill in the detergent and tackifier. Then press the button "Power." Select the proper procedures and functions and press the button "Start/Pause".

Select the procedure

The proper washing procedures should be selected according to the types, quantities, and dirtiness of the clothes to be washed in combination with the following washing temperature table.

Operating Instructions

Extra Hot (Hot+)	Seriously stained, pure white cotton or flax (for example: coffee table cloths, canteen table cloths, towels, bed sheets)
Hot	Moderately stained, colorful flax, cotton and synthetic articles with certain decolorizing degree (for example: shirts, night pajamas; Slightly stained, pure white flax (for example: underwear)
Warm	Normally stained articles (including synthetic and wool)

Table of washing procedures

Model: EFL2724BW

Program	Washing Load (lb)	Temp. (°F)	Default Time(H)	Spin Speed	Time Save	Extra Rinse	Easy Iron	Pre Wash	Delay
	26	Default							
Normal/Cotton	26	Warm	0:55	Med	○	○	○	○	○
Perm Press	13	Warm	0:57	Low	○	○	○	○	○
Heavy Duty	26	Hot	1:40	High	○	○	○	○	○
Bulky/Large	13	Eco	1:23	High	○	○	○	○	○
Sports Wear	13	Warm	0:57	Highest	○	○	○	○	○
Spin Only	26	—	0:13	High	—	—	○	—	○
Drain Only	26	—	0:01	—	—	—	—	—	○
Rinse & Spin	26	—	0:23	High	—	—	○	—	○
Tub Clean	—	Hot+	1:28	—	—	—	—	—	○
Cold Wash	26	Cold	1:09	High	—	○	○	—	○
Sanitary	13	Hot+	2:18	High	—	○	○	○	○
Baby Wear	26	Hot	1:37	High	—	○	○	○	○
Wool	4.41	Eco	1:01	Med	—	○	—	—	○
Delicates	5.51	Eco	0:58	Med	—	○	—	—	○
Quick Wash	4.41	Warm	0:36	Med	—	—	—	—	○

● Means must ○ Means optional

Energy test program: Normal/Cotton.

Note!

- The parameters in this table are only for user's reference. The actual parameters maybe different with the parameters in above mentioned table.

Operating Instructions

Table of washing procedures

Program	Washing/ Drying Load(lb)	Temp.(°F)	Default Time(H)	Time Save	Extra Rinse	Delay	Soil Level	Spin Speed
	26	Default	12.0 1400					
☼ Normal/Cotton	26/13	Warm	1:04	○	○	○	Med	Med
☼ Perm Press	13/6.61	Warm	4:27	○	○	○	Med	High
☼ Heavy Duty	26/13	Hot	1:40	○	○	○	Heavy	High
Bulky/Large	13	Eco	1:23	○	○	○	Med	High
Sports Wear	13	Warm	0:57	○	○	○	Heavy	Highest
Spin Only	26	—	0:13	—	—	○	—	High
Rinse & Spin	26	—	0:23	—	—	○	—	High
Tub Clean	—	Hot ⁺	1:28	—	—	○	—	—
☼ Timed Dry	-/1.76/2.21/6.61	—	1:29	—	—	○	—	Highest
☼ Auto Dry	-/13	—	4:19	—	—	○	—	Highest
Sanitary	13	Hot ⁺	2:18	—	○	○	Heavy	High
Baby Wear	26	Hot	1:37	—	○	○	Med	High
Wool	4.41	Eco	1:01	—	○	○	Med	Med
Delicates	5.51	Eco	0:58	—	○	○	Med	Med
☼ Quick Wash	4.41	Cold	1:55	—	—	○	Light	High

● Means must ○ Means optional

Energy test program: Normal/Cotton.

“Normal/Cotton” is the standard washing programs to which the information in the label and the fiche relates, and they are suitable to clean normally soiled cotton laundry and that they are the most efficient programs in terms of combined energy and water consumptions for washing that type of cotton laundry, that the actual water temperature may differ from the declared cycle temperature.

Note!

- The parameters in this table are only for user's reference. The actual parameters maybe different with the parameters in above mentioned table.
- The program with ☼ can be chosen for dry function.

Care and Cleaning

Care and cleaning

Before your maintenance start, pull the power plug out or disconnect the power and close the tap.



WARNING

- Solvents are forbidden to avoid that the washing machine is damaged, and toxic gases are generated or exploded.
- Never use water to wash the washing machine.
- It is forbidden that the detergents containing PCMX are used to clean the washing machine.
- Certain internal parts are intentionally not grounded and may present a risk of electric shock only during service. Service Personnel-Do not contact the following parts while the appliance is energized: Electrical Valve, Drain Pump, Door Lock, Dry Heater (Combo), Fan Motor (Combo).

Maintenance and cleaning of washing machine cabinet

Proper maintenance on the washing machine can extend its working life. The surface can be cleaned with diluted non-abrasive neutral detergents when necessary. If there is any water overflow, use the wet cloth to wipe it off immediately. No sharp items are allowed to strike the cabinet.

Notes: formic acid and its diluted solvents or equivalent are forbidden.

Clean internal drum

The rust left inside the drum by the metal articles should be removed immediately with chlorine-free detergents.

Never use steel wool.

Disposing a frozen washing machine

When the temperature drops below zero and your washing machine gets frozen, you may:

1. Disconnect the power supply for the washing machine.
2. Wash the tap with warm water to loosen inlet pipe.
3. Take down inlet pipe and immerse it in warm water.
4. Pour warm water into washing drum and wait for 10 minutes.
5. Reconnect inlet pipe to the tap and check whether inlet and outlet are working normally.

Note: when the washing machine is reused, make sure the ambient temperature is above 32°F

Anti-freeze

If the washing machine is located in the room where it can easily freeze, thoroughly drain the remaining water inside the drain and inlet pipe.

Remove the remaining water in inlet pipe:

1. Close the tap.
2. Screw off the inlet pipe from tap and put its end into the container.
3. Start up any procedure except single Wash or Drain procedure. Water will be drained out of inlet pipe if any for about 40 seconds.
4. Reconnect the inlet pipe to tap.

Care and Cleaning

Care and cleaning

Remove the remaining water in drain pump



WARNING

To avoid burning, it shall be done after the hot water inside the machine cools down.

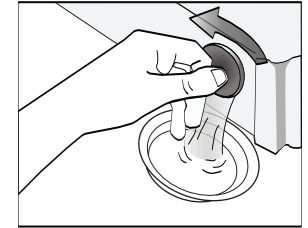

Clean detergent box and grooves

Clean detergent drawer and grooves

1. Press down the arrow location on softener cover inside the drawer.
2. Lift the clip up and take out softener cover and wash all grooves with water.
3. Restore the softener cover and push the drawer into position.

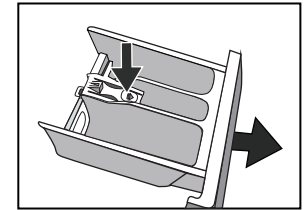

Clean inlet filter

Inlet filter should be cleaned if there is not any or insufficient water in when the tap is opened.

Clean the tap filter:

1. Close the tap.
2. Select any procedure except "Wash" or "Drain" procedure.
3. Press the button "Start/Pause" and keep the procedure running for about 40 seconds.
4. Remove the inlet pipe from the tap.
5. Use water to wash the filter.
6. Reconnect the inlet pipe.

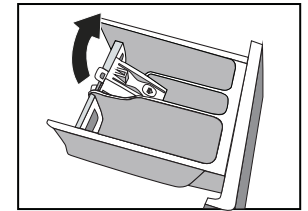

Washing the filter in washing machine:

1. Screw off the inlet pipe from the backside of the machine.
2. Pull the filter out with long nose pliers and reinstall it back after being washed.
3. Reconnect the inlet pipe.
4. Open the tap and make sure there is no water leakage.
5. Close the tap.

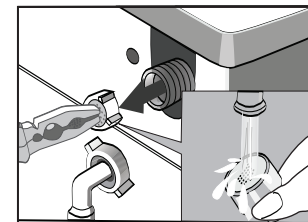
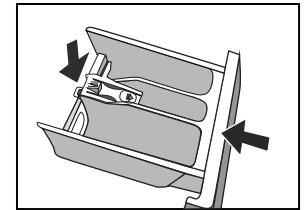

Care and Cleaning

Care and cleaning



Pull out the power plug to avoid electrical shock before washing.
After using the washing machine, pull out the power cord and close the door

WARNING tightly to avoid pinching the kids.

Remove foreign matters

Drain pump filter:

Drain pump filter can filter the yarns and small foreign matters from the washings.
Clean the filter periodically to ensure the normal operation of washing machine.



According to the soil level within the cycles and the frequency of the cycles, you have to inspect and clean the filter regularly.

The pump should be inspected if the machine does not empty and/or spin;

WARNING The machine makes an unusual noise during draining due to objects such as safety pins, coins etc. blocking the pump.

The service panel proceed as follows:

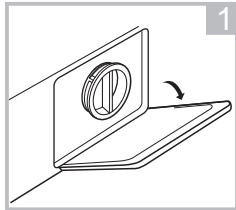

1. Open the lower cover cap

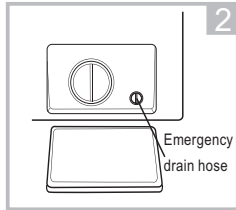

2. Rotate 90° and pull out the emergency drain hose, and take off the hose cap

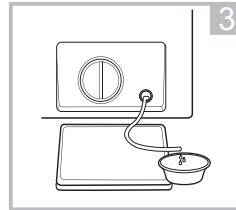

3. After water runs out, reset the drain hose

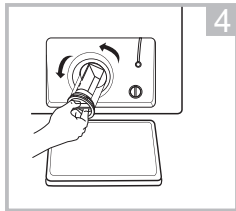

4. Open the filter by turning to the counterclockwise

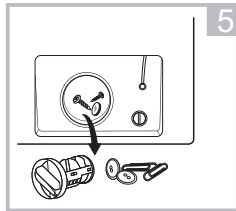

5. Remove extraneous matter

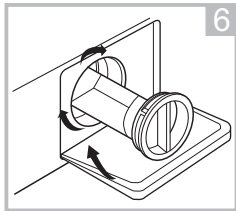

6. Close the lower cover cap

Warning!

When the appliance is in use and depending on the selected program, there can be hot water in the pump. Never remove the pump cover during a wash cycle, always wait until the appliance has finished the cycle, and is empty. When replacing the cover, ensure it is securely tightened.

Care and Cleaning

Care and cleaning

Emergency Door Release

In case of power failure or other circumstances and door cannot be opened. If it is necessary to open the door under this circumstances, pull down the pull cord inside emergency door and restore the pull cord after opening the door.

Emergency door pull cord

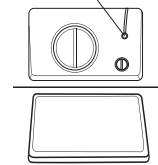

1. Open filter door

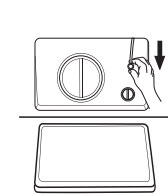

2. Emergency pull cord

Warning!

The machine is not allowed to use the emergency switch pull cord during washing. If the washer needs to run, it is recommended to open door after water is cooled to avoid getting a burn caused by high temperature residual water outflow from the machine tub.

Troubleshooting Tips

Troubleshooting tips

Troubles	Reason	Solution
Washing machine cannot start up		Check if the door is closed tightly. Check if power plug is inserted well. Check if water supply tap is opened. Check if button "On/Off" is pressed. Check if button "Start/Pause" is pressed.
Door cannot be opened	Machine's safety protection design is working.	Disconnect the power.
Heating fault	NTC is damaged and heating pipe is aging.	Can normally wash the clothes. Only cannot wash with heating. Contact the service center promptly.
Water leakage	The connection between inlet pipe or outlet hose and tap or washing machine is not tight. Drain pipe in the room is blocked.	Check and fasten water pipes. Clean up outlet hose and ask a specialized person to repair it when necessary.
Water is overflow from the bottom of the machine	The inlet pipe is not connected firmly. Outlet hose has water leakage.	Fix the inlet pipe. Replace the drain hose.
Indicator or display does not light.	Power is disconnected. PC board has problems. Harness has connection problem.	Check if the power is shut down and power plug is connected correctly. If not, call the service center.
Detergent residues in the box	Washing powder is dampened and agglomerated.	Clean and wipe the box. Use liquid detergents or the detergents special for drum.
Washing effects are not good	The clothes are too dirty. Insufficient detergent quantity.	Select a proper procedure. Add the proper detergent quantity according to the instructions in detergent package.
Abnormal noise Great vibration		Check if the fixing (bolts) has been removed. If cabinet is installed on the solid and level floor. Check if there are any barrettes or metal articles inside. Check if the legs in the washing machine are level.

Remove the Problems

Remove the problems

The start of the appliance does not work or it stops during operation. First try to find a solution to the problem. If not, contact a serviceman.

Description	Reason	Solution
Washing machine cannot start up	Door is not closed properly	Restart after the door is closed Check if the clothes is stuck
Door can't be opened	Washer's safety protection design is working	Disconnect the power, restart the product
Water leakage	The connection between inlet pipe or outlet hose is not tight	Check and fasten water pipes Clean up outlet hose
Detergent residues in the box	Detergent is dampened or agglomerated	Clean and wipe the detergent box
Indicator or display does not light	Disconnect the power PC board or harness has connection problem	Check if the power is shut down and the power plug is connected correctly
Abnormal noise		Check if the fixing (bolts) have been removed Check it's installed on a solid and level floor

Description	Reason	Solution
E30	Door is not closed properly	Restart after the door is closed Check if the clothes is stuck
E10	Water injecting problem while washing	Check if the water pressure is too low Straighten the water pipe Check if the inlet valve filter is blocked
E21	Overtime water draining	Check if the drain hose is blocked
E12	Water overflow	Restart the washer
EXX	Others	Please try again first, call up service line if there are still troubles

Note!

- After the check, activate the appliance. If the problem occurs or the display shows other alarm codes again, contact the service.

Appendix

Appendix

Care Label

Graphic Symbol	Illustration	Graphic Symbol	Illustration
	Hand Wash		No Machine Wash
	Washing (including Machine Wash and Hand Wash)		Do not Wash
	Dry Clean		No Dry Clean
	Warmly Dry Clean		No Wring
	Bleach		No Bleach
	Tumble dry		Do not Tumble Dry
	Iron		Do not Iron
	Steam Iron		Iron with Cloth
	Medium Temperature and Max. Temperature 302°F		Dry after Wash
	Line Dry		Line Dry in Shade

To avoid fire, electrical shock and other accidents, remember the following reminding:

- Only the voltage indicated in power label can be used. If you are not clear of the voltage at home, contact the local power bureau.
- When you are using the heating function, the maximum current through the washing machine will reach 12A. Therefore, make sure the power supply units (current, voltage and cable) can meet the normal load requirements for the machine.
- Protect the power cord properly. Power cord should be fixed well so that it will not trip the people or other things and be damaged. Special attention should be paid to the socket. It should be plugged into the sockets easily and attention should be paid to the plug location.
- Do not make the wall-mounted socket overloaded or cable extended. Overloading of the wiring may cause fire or electrical shock. Do not pull out power plug with wet hand.
- To ensure your safety, power plug should be inserted into an earthed three-pole socket. Carefully check and ensure that your socket is properly and reliably earthed.

Technical Specifications

Technical specifications

Model:EFL2724BW

Parameter	
Power Supply	120V~, 60Hz
Dimension(W*D*H)	23.5*24*33.5 in
Net Weight	161lb (73kg)
Washing Capacity	26lb (12.0kg)
Rated Current	11A
Standard Water Pressure	0.05MPa~1MPa



WARNING

LEGAL NOTICES

ELECTRICAL INFORMATION

THIS APPLIANCE MUST BE GROUNDED.

This appliance is fitted with a plug suitable for use in all houses fitted with sockets to current specifications.

If the fitted plug is not suitable for your socket outlets, it should be cut off and carefully disposed of. To avoid a possible shock hazard, do not insert the discarded plug into a socket.

This appliance complies with the following EEC Directives:

2014 / 35/ EU (Low Voltage Directive)

2014 / 30/ EU (EMC Directive).

WARRANTY

This Product (including any accessories included in the original packaging) as supplied and distributed in new condition, is warranted by Element Appliance Company, LLC ("Element") to the original customer who purchases the Product from an authorized Element retailer (the "Original Customer" or "you") against defects in material and workmanship under proper use, maintenance, and care according to the owner's manual, warnings, and instructions accompanying the Product ("Warranty") as follows:

* PLEASE NOTE – Proof of purchase evidencing the date of purchase by the Original Purchaser from an authorized Element retailer ("Valid Proof of Purchase") is **required** for all Warranty service. The express Warranty set forth herein is subject to all terms and conditions set forth below.

CORRECT DISPOSAL OF THIS PRODUCT

Old appliances still have some residual value. An environmentally friendly method of disposal will ensure that valuable raw materials can be recovered and used again.



This marking indicates that this product should not be disposed with other household wastes throughout the US. To prevent possible harm to the environment or human health from uncontrolled waste disposal, recycle it responsibly to promote the sustainable reuse of material resources. To return your used device, please use the return and collection systems or contact the retailer where the product was purchased. They can take this product for environmentally safe recycling.

1. WARRANTY SERVICE:

- A. **ONE-YEAR WARRANTY:** Except as provided in subpart 1.B below, for a period of **one (1) year** from the date of purchase by the Original Customer (the "Warranty Period"), if the parts or components covered by this Warranty are determined by Element or Element's authorized service provider to be defective in material or workmanship, Element will, at its sole and absolute discretion and option: (i) repair the defective part or component at no charge to the Original Customer, (ii) replace the defective Product with a new Product of similar or better quality, at no charge to the Original Customer, or (iii) refund the documented purchase price paid by the Original Customer (excluding tax) to the Original Customer upon return of the defective Product as directed by Element. After the Warranty Period expires, the Original Customer must pay for all parts, components, shipping and handling, labor, and replacement costs associated with the Product or any part or component thereof,

regardless of any defects in the Product or any part or component thereof.

- B. **LIMITED EXTENDED WARRANTY THROUGH PRODUCT REGISTRATION:** If and only if the Original Customer registers the Product at www.elementelectronics.com within **ninety (90)** days of the date of purchase by the Original Customer, then the Warranty Period discussed in subpart 1.A. above shall be extended an additional one (1) year to a new Warranty Period equaling **two (2) years** from the date of purchase by the Original Customer. If the Product is not registered as provided for in this subpart 1.B, then the standard one-year Warranty Period set forth in subpart 1.A shall apply.
- C. **TIMING AND PROCEDURE:** Before Warranty service can commence, the Original Customer must contact either (i) the retailer from whom the Original Customer purchased the Product, or (ii) Element directly, in either case for problem determination and service procedures. Valid Proof of Purchase evidencing that the Product is within the Warranty Period **MUST** be presented by Original Customer in order to obtain the requested Warranty service. Please have your model and serial number available, along with your date of purchase of the Product. To remain eligible for Warranty service, Original Customer may not return the Product or any part or component thereof to the retailer or Element without Element's prior written consent.

2. EXCLUSIONS AND LIMITATIONS TO WARRANTY SERVICE

The Warranty covers manufacturing defects in materials and workmanship of the Product encountered in the normal, non-commercial use of the Product, and **does not cover** (a) damages or malfunctions resulting from improper or unreasonable use or maintenance, abuse, negligence, failure to follow instructions contained in any written materials that accompany the Product, deterioration by reason of excess moisture, corrosive atmosphere, lightning, power surges, connections to improper voltage supply, unauthorized

alteration, or other external causes such as extremes in temperature or humidity, modifications, scratches or discoloration; (b) improper or incorrectly performed repairs by service providers not authorized by Element; (c) transportation, shipping, delivery, pickup, insurance, installation, or set-up costs; (d) ordinary wear and tear, cosmetic damage, or damage due to acts of nature, including but not limited to, water, floods, wind, storm, tornado, earthquake, or fire, or due to damage caused by extraordinary impact events, such as dropping, crushing, demolition or other extraordinary damage; (e) commercial use of the Product, or use of the Product for anything other than single-family household or residential use; or (f) modification of the Product or any part of the Product.

This Warranty is made to the Original Customer only and does not cover Products sold AS IS or WITH ALL FAULTS. The Warranty is invalid if the factory-applied serial number has been altered or removed from the Product. This Warranty is valid only in the United States, and only applies to Product if it was purchased and serviced in the United States. The addition of equipment or features to the Product that are not manufactured or recommended by Element could affect the intended function of the Product, and therefore may void the Warranty. Furthermore, the exposure of the Product to chemicals, heat, cold, humidity, or other elements can affect the Product components, and therefore, the Warranty does not cover discoloration, fading, cosmetic changes, rust, or any damages or failure related to any such items. The Warranty is contingent upon the proper use, maintenance, and care of the Product. The Warranty may be void if the Product has been used in a manner contradictory to, or in violation of, the terms of the user's manual, warnings, or instructions accompanying the Product.

THIS WARRANTY IS MADE IN LIEU OF AND SUPERSEDES ALL OTHER WARRANTIES OR CONDITIONS OF MERCHANTABILITY OR FITNESS FOR A PARTICULAR PURPOSE OR GENERAL USE, WHETHER EXPRESS, IMPLIED, COLLATERAL,



STATUTORY, OR PROVIDED BY COMMON LAW, THE UNIFORM COMMERCIAL CODE, OR OTHERWISE. ELEMENT FURTHER DISCLAIMS ALL WARRANTIES AFTER THE END OF THE WARRANTY TERM DEFINED ABOVE. NO OTHER EXPRESS WARRANTY OR GUARANTY GIVEN BY ANY OTHER PERSON, FIRM, OR ENTITY WITH RESPECT TO THE PRODUCT SHALL BE BINDING ON ELEMENT. REPAIR, REPLACEMENT, OR REFUND OF THE ORIGINAL PURCHASE PRICE, AT ELEMENT'S SOLE DISCRETION, ARE THE EXCLUSIVE REMEDIES OF THE CUSTOMER.

ELEMENT SHALL NOT BE LIABLE FOR ANY INCIDENTAL OR CONSEQUENTIAL DAMAGES CAUSED BY THE USE, MISUSE, OR INABILITY TO USE THE PRODUCT. THESE INCLUDE, BUT ARE NOT LIMITED TO, ANY DAMAGES IN THE FORM OF LOST PROFITS, LOSS OF USE, LEGAL FEES, ECONOMIC LOSS, PERSONAL INJURIES, OR ANY OTHER DAMAGES CAUSED BY CIRCUMSTANCES BEYOND THE CONTROL OF ELEMENT. NOTWITHSTANDING THE FOREGOING, ELEMENT'S AGGREGATE LIABILITY TO ANY CUSTOMER SHALL NOT EXCEED THE ORIGINAL PURCHASE PRICE OF THE PRODUCT. THIS WARRANTY SHALL NOT EXTEND TO ANYONE OTHER THAN THE ORIGINAL CUSTOMER WHO PURCHASED THE PRODUCT, AND IS NOT TRANSFERRABLE. NO PERSON IS AUTHORIZED TO ALTER, EXTEND, OR WAIVE THIS WARRANTY OR ANY OF ITS TERMS OR CONDITIONS.

Some states do not allow the exclusion or limitation of incidental or consequential damages, or allow limitations on warranties, so the above limitations or exclusions may not apply to you. This Warranty gives you specific rights, and you may have other rights, which vary from state to state. The exclusions and limitations to the Warranty apply to the maximum extent permitted by law and unless restricted or prohibited by law. Where any term of this Warranty is prohibited by applicable law, it shall be null and void, but the remainder of this Warranty shall remain in effect.

PLEASE CONTACT THE RETAILER FROM WHOM YOU PURCHASED THE PRODUCT FOR CUSTOMER SERVICE OR TO CONFIRM PROCEDURES FOR WARRANTY SERVICE.

In the event you wish to contact Element, please direct all correspondence to:

Element Appliance Company, LLC

customerservice@elementelectronics.com

888-842-3577

<https://elementelectronics.com/appliances>